

Applications

The AM-709 damper shaft position indicator is used in short shaft applications to show the shaft position.

The AM-710 universal clamp is used to clamp the actuator up to 3/4" dia. round shaft or up to 1/2" square shaft.

The AM-711 crankarm attaches to the actuator and provides a crankarm for shafts up to 1/2" dia.

The AM-712 is a crankarm kit that includes the crankarm (AM-711) plus an actuator mounting bracket, three sheet metal screws, and three self-tapping screws. This kit is used to mount the actuator and provide a crankarm for shafts up to 1/2" dia.

The AM-713 is a mounting bracket for Honeywell Mod IV M6415-type actuators.

The AM-715 is a crankarm kit that includes the crankarm (AM-711) plus an angled plate mounting bracket (AM-713), and two self-tapping screws. This kit is used to mount the actuator and provide a crankarm for shafts up to 1/2" dia. This kit can be used for Honeywell Mod IV M6415-type actuators.

The AM-717 replacement universal clamp assembly is used to clamp the actuator to 5/8" dia. round shafts or up to 1/2" square shafts. Available to replace lost standard clamps shipped with actuator.

The AM-761 replacement anti-rotation bracket is used to secure the actuator and prevent it from rotating around the shaft. Available to replace lost anti-rotation brackets shipped with the actuator.

Applicable Literature

- Cross-Reference Guide, F-23638
- MA40-7XX3, MA40-7XX3-50X, MA40-7XXX, MA40-7XXX-50X Schneider Electric Spring Return Two-Position SmartX Actuators General Instructions, F-26642
- MF40-7XX3, MA40-7XX3-50X Schneider Electric Spring Return Floating SmartX Actuator General Instructions, F-26644
- MS40-7XX3, MS40-7XX3-50X Schneider Electric Spring Return Proportional SmartX Actuator General Instructions, F-26645
- MX40-7XXX and MX40-6XXX Series Schneider Electric Actuator Selection Guide, F-26646

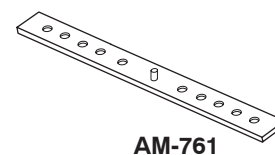
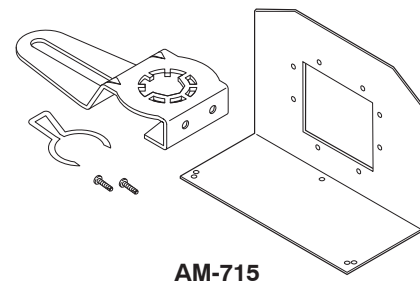
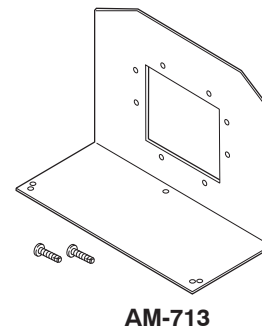
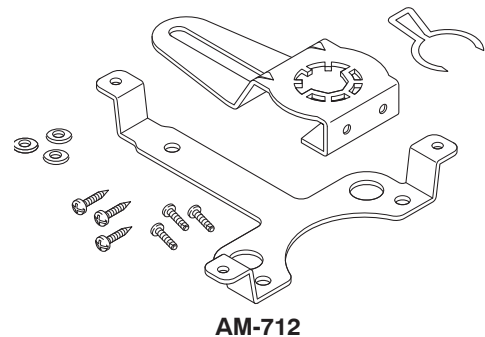
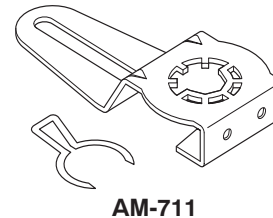
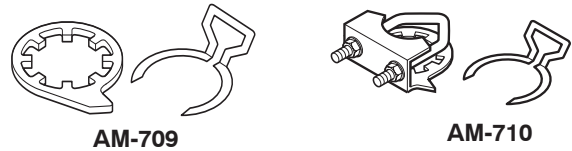

2 Specifications

Table-1 Model Chart.

Part Number	Compatible Actuators	Description		Tools Required
AM-709	MX40-704X	Damper Position Indicator	Shaft Sizes: - Up to 3/4" round shaft - Up to 1/2" square - Secured to actuator with retaining ring	
AM-710		Universal Clamp	Shaft Sizes: - Up to 3/4" round - Up to 1/2" square	10 mm wrench
AM-711		Crankarm	Shaft Sizes: - Up to 1/2" round - Secured to actuator with retaining ring	10 mm and 7/16" wrench
AM-712		Crankarm Kit	Contains: - AM-711 Crankarm - Mounting Bracket - 3 #10 self tapping screws - 3 #10 washers - 3 #8 sheet metal screws	Screw drivers (torx and flat) 10 mm and 7/16" wrench Drill No. 24 drill bit for #8 sheet metal screws.
AM-713		Mounting Bracket Kit	Contains: - Mounting Bracket - 2 #8 self tapping screws	Screw driver 10 mm and 7/16" wrench Drill No. 24 drill bit for #8 screws
AM-715		Crankarm Kit	Contains: - AM-711 Crankarm - AM-713 Universal Mounting Bracket (includes the following) - Mounting Bracket - 2 #10 self tapping screws Customer supplied parts: - 3 #8 sheet metal screws	Screw drivers (torx and flat) 10 mm and 7/16" wrench Drill No. 24 drill bit for #8 sheet metal screws.
AM-717		Replacement Universal Clamp	Shaft Sizes: - Up to 5/8" round shaft - Up to 1/2" square - To replace lost standard clamps shipped with actuator	10 mm wrench
AM-761		Replacement Anti-Rotation Bracket	- To replace lost standard anti-rotation brackets shipped with actuator	

Installation

Inspection

Inspect the package for damage. If damaged, notify the appropriate carrier immediately. If undamaged, open the package and inspect the device for obvious damage. Return damaged products.

Requirements

- Tools (not provided):
 - See Model Chart
 - Torque wrench with appropriate socket
- Training: Installer must be a qualified, experienced technician.

Mounting

AM-709 Damper Position Indicator/Stroke Limiter

The AM-709 is used for MX40-704X actuators mounted on a short length shaft, 3/4 to 3-1/2" (19 to 89 mm).

Note:

For general information on the MX40-704X actuators, refer to the General Instructions listed in the Applicable Literature section.

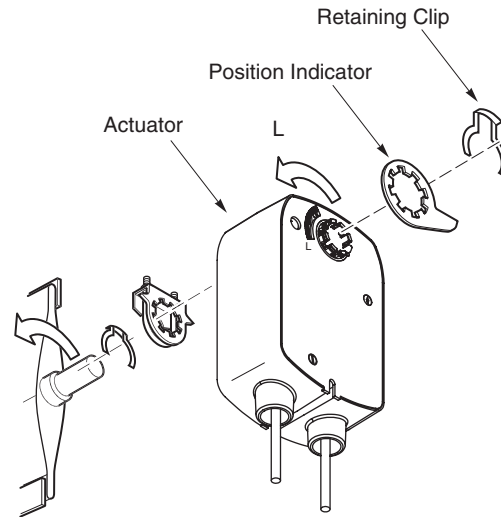

Figure-1 Short Shaft Mounting of Position Indicator.

Place the position indicator on the actuator as shown in Figure-1. Secure in place, using the retaining clip provided.

To Limit Stroke of Actuator

The Stop Block is used in conjunction with the tab on the universal clamp or the AM-709 position indicator. In order to function properly, the clamp or indicator must be mounted correctly.

The Stop Block controls the rotational output of the MX40-704X and MX40-704X-501 actuators. It is used in applications where a damper has a designed rotation that is less than 90°, for example a 45° or 60° rotating damper.

1. Determine the amount of damper rotation required. The actuator stop block provides limited rotation from 40° to 95°.
2. Loosen the screw securing the stop block to the actuator.

Note:

The actuator is shipped with the Stop Block mounted to the “L” side. If the damper application requires the “R” side to face the installer, simply remove the Stop Block and screw and move it to the new location.

3. Loosen the screw securing the stop block to the actuator.
4. Slide the stop block into position, so that its edge lines up with the degree graduation on the actuator face which corresponds with the required rotation. See Figure-2.
5. Secure the stop block in place.
6. Test the damper rotation by applying power. Re-adjust if necessary.

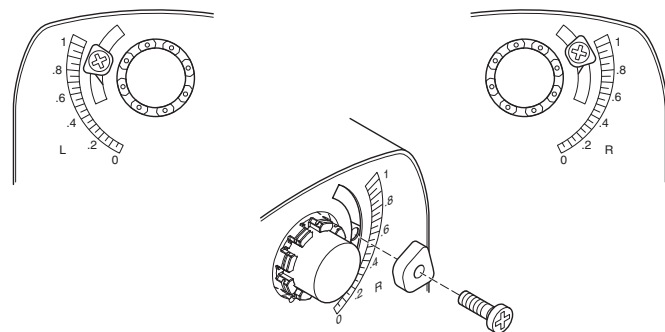

Figure-2 Adjusting Stop Block for Limited Rotation.

AM-710 Universal Clamp

The AM-710 is used for MX40-704X actuators mounted on shafts that are 3/4" diameter or 1/2" square. The AM-710 is required whenever the AM-676 shaft extension is used.

Note: For general information on the MX40-704X actuators, refer to the General Instructions listed in the Applicable Literature section.

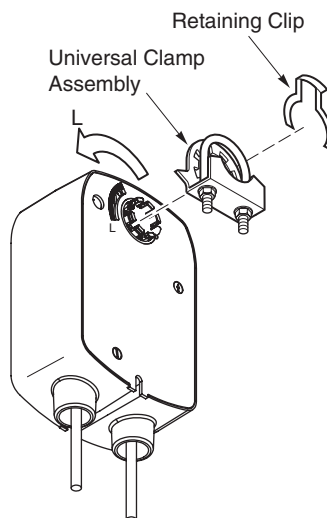

Figure-3 Mounting of Universal Clamp.

1. Replace the factory installed universal clamp with the AM-710 universal clamp. Remove the retaining clip and original universal clamp from the actuator.
2. Place the AM-710 universal clamp in the same orientation as the universal clamp previously installed on the actuator. Secure it in place using the retaining clip. See Figure-3.

AM-711 Crankarm

Note: For general information on the MX40-704X actuators, refer to the General Instructions listed in the Applicable Literature section.

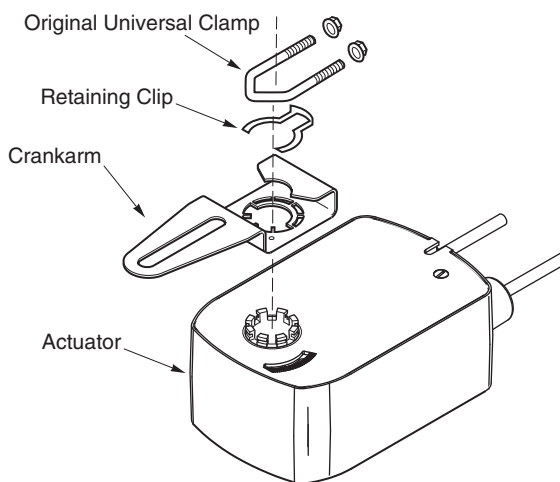

Figure-4 Mounting AM-711 Crankarm.

1. Remove the universal clamp from the damper actuator.
2. Install the AM-711 crankarm onto the damper actuator. Slide the crankarm into place replacing the universal clamp previously removed.

3. Secure the crankarm in place using the retaining clip provided. See Figure-4. Place the retaining clip inside the crankarm, making sure to align the retaining clip with the grooves on the actuator mounting. Push the retaining clip with finger pressure until it clicks into place.
4. Insert the universal clamp into the holes on the crankarm and secure in place, using the two nuts provided. Apply torque to 4 to 6 ft-lbs (5.4 to 8 N-m).

AM-712 Crankarm

Note: For general information on the MX40-704X actuators, refer to the General Instructions listed in the Applicable Literature section.

1. Locate the pre-drilled mounting holes on the actuator label that are covered by a white "+" sign. See Figure-5.
2. Puncture the three locations that will be used for the mounting brackets.



Caution: Do not drill holes in the actuator body. Use #10 self-tapping screws provided with accessory kit to screw into actuator body.

3. Use the #10 self-tapping screws and washers to secure the bracket to the actuator.
4. If required, use a No. 24 drill bit on the appropriate mounting holes and tighten the #8 sheet metal screws.
5. Install the AM-711 crankarm onto the damper actuator. Slide the crankarm into place replacing the universal clamp previously removed.

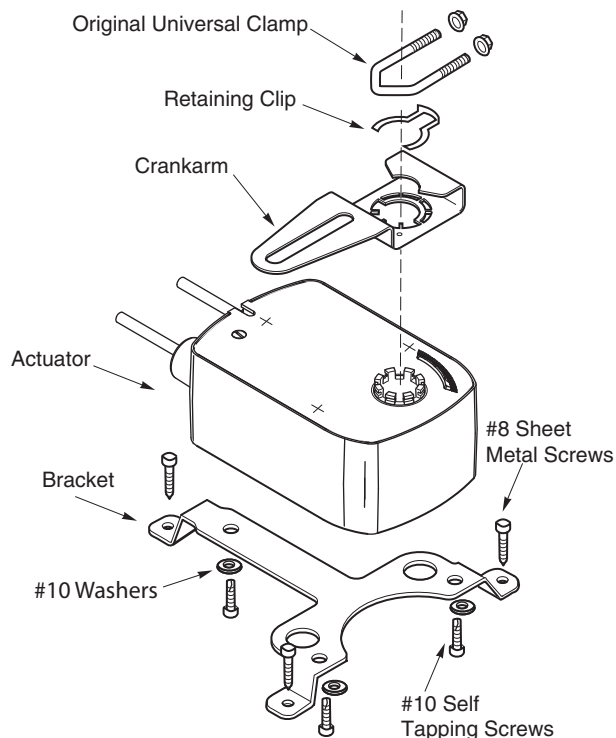

Figure-5 Mounting AM-712 Crankarm.

6. Secure the crankarm in place using the retaining clip provided. See Figure-5. Place the retaining clip inside the crankarm, making sure to align the retaining clip with the grooves on the actuator mounting. Push the retaining clip with finger pressure until it clicks into place.
7. Insert the original universal bolt into the holes on the crankarm and secure in place, using the two flanged nuts provided. Apply torque to 4 to 6 ft-lbs (5.4 to 8 N-m).

AM-713 Mounting Bracket Kit

Note:

For general information on the MX40-704X actuators, refer to the General Instructions listed in the Applicable Literature section.

1. Locate the pre-drilled mounting holes on the actuator label that are covered by a white “+” sign. See Figure-6.
 2. Puncture the two locations near the shaft that will be used for the mounting bracket.
-

**Caution:**

Do not drill holes in the actuator body. Use #10 self-tapping screws provided with accessory kit to screw into actuator body.

3. Use the #10 self-tapping screws to secure the bracket to the actuator, see Figure-6.
 4. To secure the actuator/bracket assembly use a No. 24 drill bit on the appropriate bracket mounting holes. Secure the assembly using the #8 screws.
-

AM-715 Crankarm Kit

Note:

For general information on the MX40-704X actuators, refer to the General Instructions listed in the Applicable Literature section.

From the kit bag:

1. Locate the pre-drilled mounting holes on the actuator label that are covered by a white “+” sign. See Figure-6.
 2. Puncture the two locations near the shaft that will be used for the mounting bracket.
-

**Caution:**

Do not drill holes in the actuator body. Use #10 self-tapping screws provided with accessory kit to screw into actuator body.

3. Use the #10 self-tapping screws to secure the bracket to the actuator.
4. To secure the actuator/bracket assembly use a No. 24 drill bit on the appropriate bracket mounting holes. Secure the assembly using the #8 screws.
5. Install the AM-711 crankarm onto the damper actuator. Slide the crankarm into place replacing the universal clamp previously removed.

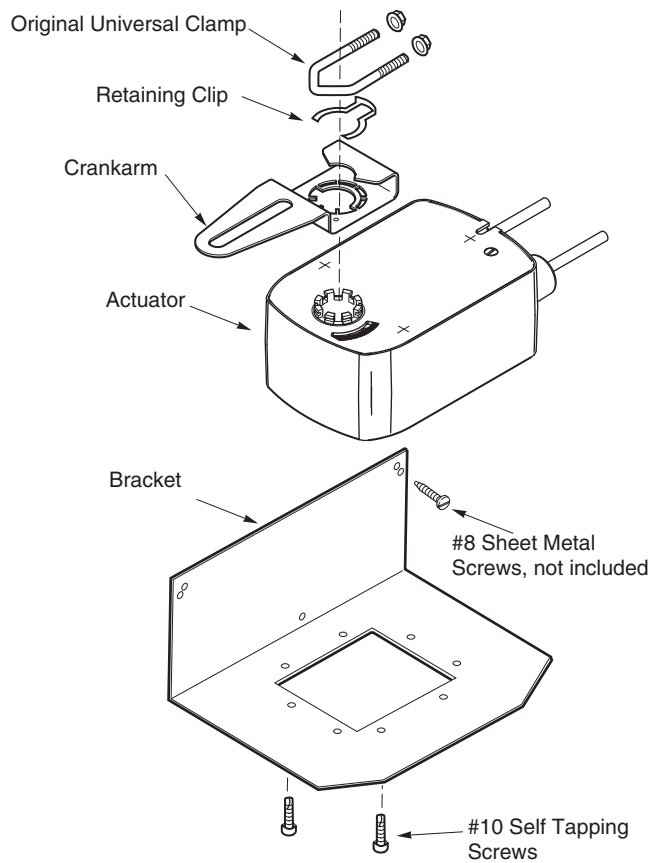

Figure-6 Mounting AM-715.

6. Secure the crankarm in place using the retaining clip provided. See Figure-6. Place the retaining clip inside the crankarm, making sure to align the retaining clip with the grooves on the actuator mounting. Push the retaining clip with finger pressure until it clicks into place.
7. Insert the original universal bolt into the holes on the crankarm and secure in place, using the two flanged nuts provided. Apply torque to 4 to 6 ft-lbs (5.4 to 8 N-m).

AM-717 Replacement Universal Clamp

The AM-717 replacement universal clamp assembly is used to clamp the actuator to 5/8" dia. round shafts or up to 1/2" square shafts. Available to replace lost standard clamps shipped with actuator.

Note:

Refer to General Instructions listed in the Applicable Literature section for universal clamp and MX40-704X installation instructions.

AM-761 Anti-Rotation Bracket

The AM-761 replacement anti-rotation bracket is used to secure the actuator and prevent it from rotating around the shaft. Available to replace lost anti-rotation brackets shipped with the actuator.

Note:

Refer to General Instructions listed in the Applicable Literature section for installation instructions.

Maintenance

AM-709 and AM-71X accessories require no maintenance. Regular maintenance of the total system is recommended to assure sustained, optimum performance.

Field Repair

None. Replace any damaged or failed parts with functional replacements.