

Installation of Esprit with Medium Lamps SMR 1-2BUUEI 5/11/15

This document describes the basic installation of specially modified Esprit SE, Esprit SE IP, and Esprit HD with two large Pelco illuminators.

Please review all standard Esprit installation and operation guides that come with the Esprit prior to proceeding with the following instructions for the specially modified Esprit.

Follow the standard Esprit instructions for power and communication cables; also follow instructions for mounting the Esprit.

Special Instructions:

1. Mount the Esprit power module to a solid surface.
2. Mount the Esprit pan and tilt unit to the power module.
 - a. Plug in the standard Esprit cable harness.
 - b. This special Esprit has a four position cable that needs to be connected.
 - i. **This requires two people.** Have one person hold the pan and tilt module while the second person connects the two halves of the 4 position cable connector as shown below.

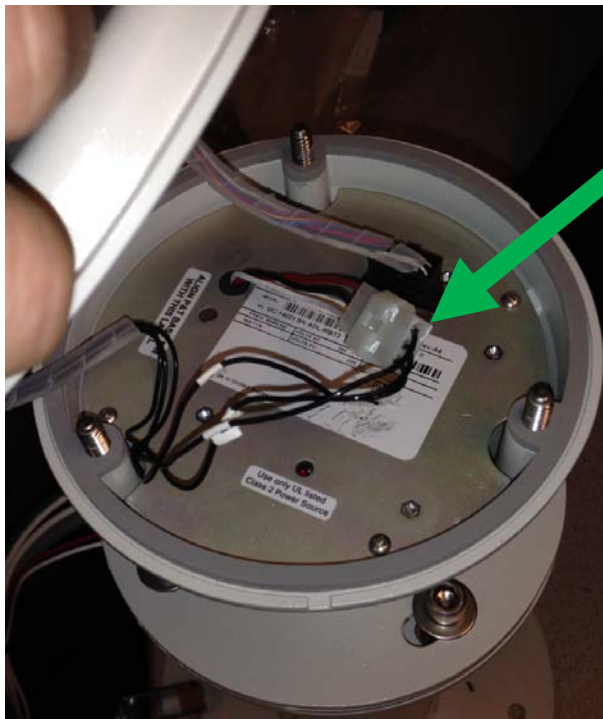

3. Mount the lamps to the Esprit (Brackets are packaged as loose items with the Esprit)
 - a. Note the adjustment points when aiming the lamps. Start with the lamps approximately parallel to the Esprit camera housing.

4. Connect the lamps to the Esprit
 - a. Prepare the cable from each lamp. Cut the cable to 18", (45.7cm) long.
 - b. Run the cables through the two glands in the bottom of the Esprit camera housing.
 - c. Wire the two Red and two Black wires per the picture.

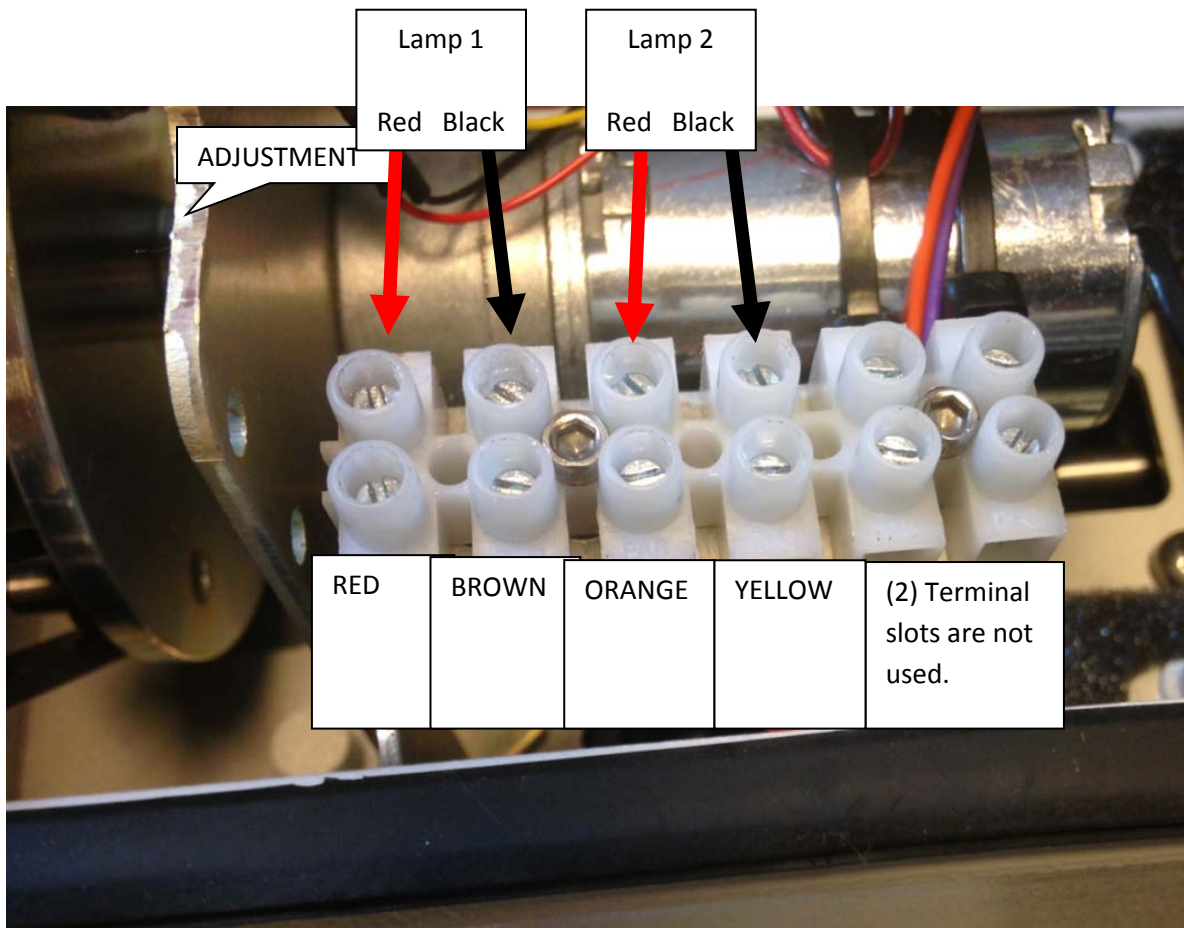

- d. Short the Orange and Purple wires from Lamp 1 together and secure with a wire nut. Repeat for Lamp 2. This step must be followed otherwise the lamps will not turn on.
 - e. The other wires in the lamp cable bundle are not used.

5. At the Esprit power module, make external connections for Esprit power, video, and communications per the standard Esprit installation guide.

6. At the Esprit power module, connect the lamp power wires to a 24VAC or 120/240VAC supply
 - a. Connect the Red & Brown wires to the 24VAC power source that will be used for lamp 1.
 - b. Connect the Orange & Yellow wires to the 24VAC power source that will be used for lamp 2.

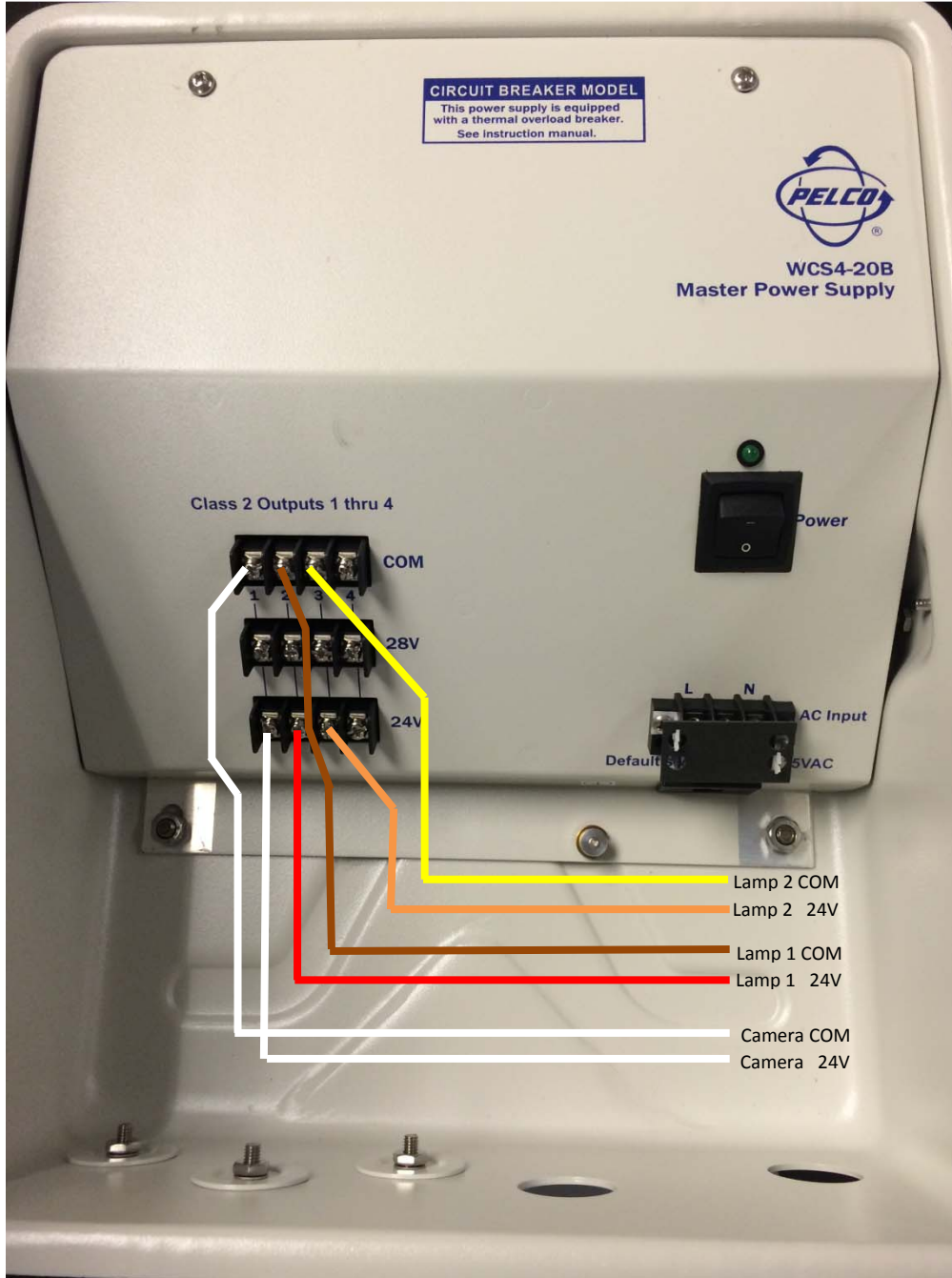

REV	ECO NO	ZONE	DESCRIPTION	DATE	BY	APP
2	-	-	RELEASE			

REV	ECO NO	ZONE	DESCRIPTION	DATE	BY	APP
2	-	-	RELEASE			

- NOTES, UNLESS OTHERWISE SPECIFIED:
- THIS DRAWING SERVES AS A REFERENCE ONLY TO DISPLAY THE INFRARED BRACKET SCHEMATIC. THIS DRAWING DOES NOT ENCOMPASS ALL COMPONENTS OF THE FUNCTIONAL SMI AND IS NOT TO BE USED AS AN ASSEMBLY DRAWING.
 - INFRARED ILLUMINATOR TYPE: RAYTEC RM50-F-X SERIES ****NOT INCLUDED****

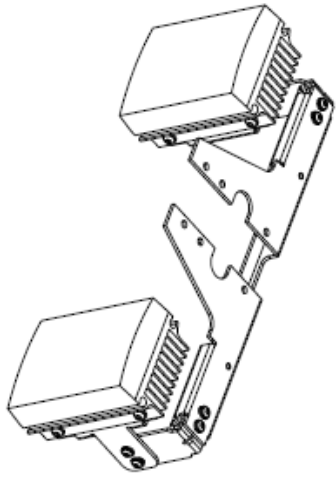
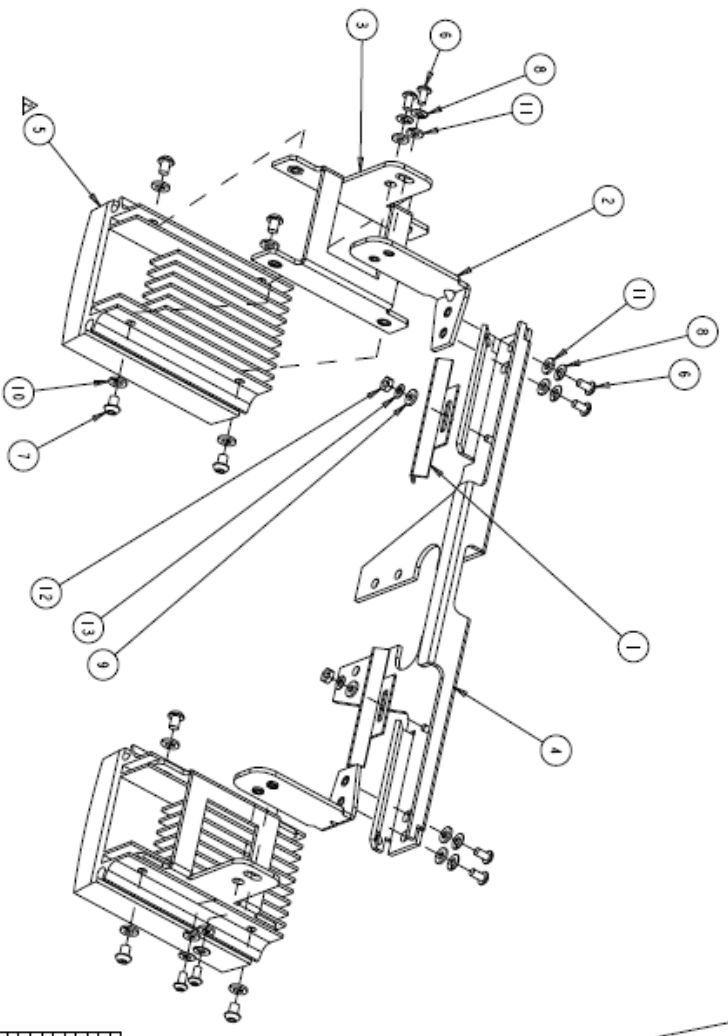

(COMPUTER DATA BASE DRAWING, PRO-E)

UNLESS OTHERWISE SPECIFIED:		UNLESS OTHERWISE SPECIFIED:		UNLESS OTHERWISE SPECIFIED:		UNLESS OTHERWISE SPECIFIED:	
DIMENSIONS ARE IN INCHES:		DIMENSIONS ARE IN INCHES:		DIMENSIONS ARE IN INCHES:		DIMENSIONS ARE IN INCHES:	
FRONT	± .005	FRONT	± .005	FRONT	± .005	FRONT	± .005
TOP	± .005	TOP	± .005	TOP	± .005	TOP	± .005
RIGHT	± .005	RIGHT	± .005	RIGHT	± .005	RIGHT	± .005
DEPTH	± .005	DEPTH	± .005	DEPTH	± .005	DEPTH	± .005
DIAMETER	± .005	DIAMETER	± .005	DIAMETER	± .005	DIAMETER	± .005
RADIUS	± .005	RADIUS	± .005	RADIUS	± .005	RADIUS	± .005
ANGLE	± .005	ANGLE	± .005	ANGLE	± .005	ANGLE	± .005
FINISH	N/A	FINISH	N/A	FINISH	N/A	FINISH	N/A
DO NOT SCALE DRAWING		DO NOT SCALE DRAWING		DO NOT SCALE DRAWING		DO NOT SCALE DRAWING	
USED ON		USED ON		USED ON		USED ON	
NEXT ASSY APPLICATION		NEXT ASSY APPLICATION		NEXT ASSY APPLICATION		NEXT ASSY APPLICATION	
THIRD ANGLE PROJECTION		THIRD ANGLE PROJECTION		THIRD ANGLE PROJECTION		THIRD ANGLE PROJECTION	
INSPECTION DIMENSION		INSPECTION DIMENSION		INSPECTION DIMENSION		INSPECTION DIMENSION	

NO.	REV	DATE	DESCRIPTION
1			INITIAL RELEASE
2			REVISION
3			REVISION
4			REVISION
5			REVISION
6			REVISION
7			REVISION
8			REVISION
9			REVISION
10			REVISION
11			REVISION
12			REVISION
13			REVISION
14			REVISION
15			REVISION
16			REVISION
17			REVISION
18			REVISION
19			REVISION
20			REVISION
21			REVISION
22			REVISION
23			REVISION
24			REVISION
25			REVISION
26			REVISION
27			REVISION
28			REVISION
29			REVISION
30			REVISION
31			REVISION
32			REVISION
33			REVISION
34			REVISION
35			REVISION
36			REVISION
37			REVISION
38			REVISION
39			REVISION
40			REVISION
41			REVISION
42			REVISION
43			REVISION
44			REVISION
45			REVISION
46			REVISION
47			REVISION
48			REVISION
49			REVISION
50			REVISION

PELCO worldwide leader in
 OEM CASE VIDEO SYSTEMS
 3550 PELCO WAY, DOWNS, CALIFORNIA 92620-9099 USA

IR BRKT ASSY, RAYTEC RM50-F-X
 SMRI-IGAI03

SIZE DWG NO. RDXX-SMRI-IGAI03 2
 SCALE: 0.250 = 1 WT. SHEET 1 OF 1