

Installation of Esprit with Large Lamps

SMR 1-26OSZH 9/24/15

This document describes the basic installation of specially modified Esprit SE, Esprit SE IP, and Esprit HD with two large Pelco illuminators.

Please review all standard Esprit installation and operation guides that come with the Esprit prior to proceeding with the following instructions for the specially modified Esprit.

Follow the standard Esprit instructions for power and communication cables; also follow instructions for mounting the Esprit.

Special Instructions:

1. Mount the Esprit power module to a solid surface.
2. Mount the Esprit pan and tilt unit to the power module.
 - a. Plug in the standard Esprit cable harness.
 - b. This special Esprit has a four position cable that needs to be connected.
 - i. **This requires two people.** Have one person hold the pan and tilt module while the second person connects the two halves of the 4 position cable connector as shown below.

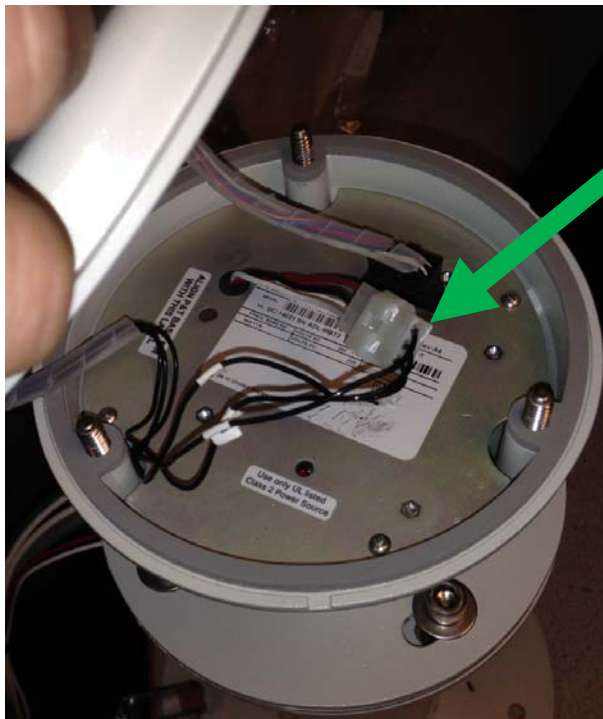

3. Mount the lamps to the Esprit (Brackets are packaged as loose items with the Esprit)
 - a. Use the bracket shown below and with four bolts and lock washers, provided, to mount the lamps to the Esprit.
 - b. Note the adjustment points when aiming the lamps. Start with the lamps approximately parallel to the Esprit camera housing.

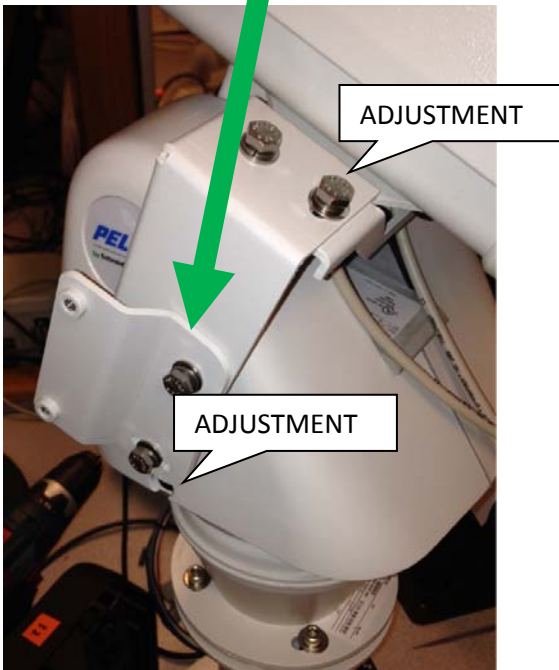

4. Connect the lamps to the Esprit
 - a. Prepare the cable from each lamp. Cut the cable to 18", (45.7cm) long.
 - b. Run the cables through the two glands in the bottom of the Esprit camera housing.
 - c. Wire the two Red and two Black wires per the picture.

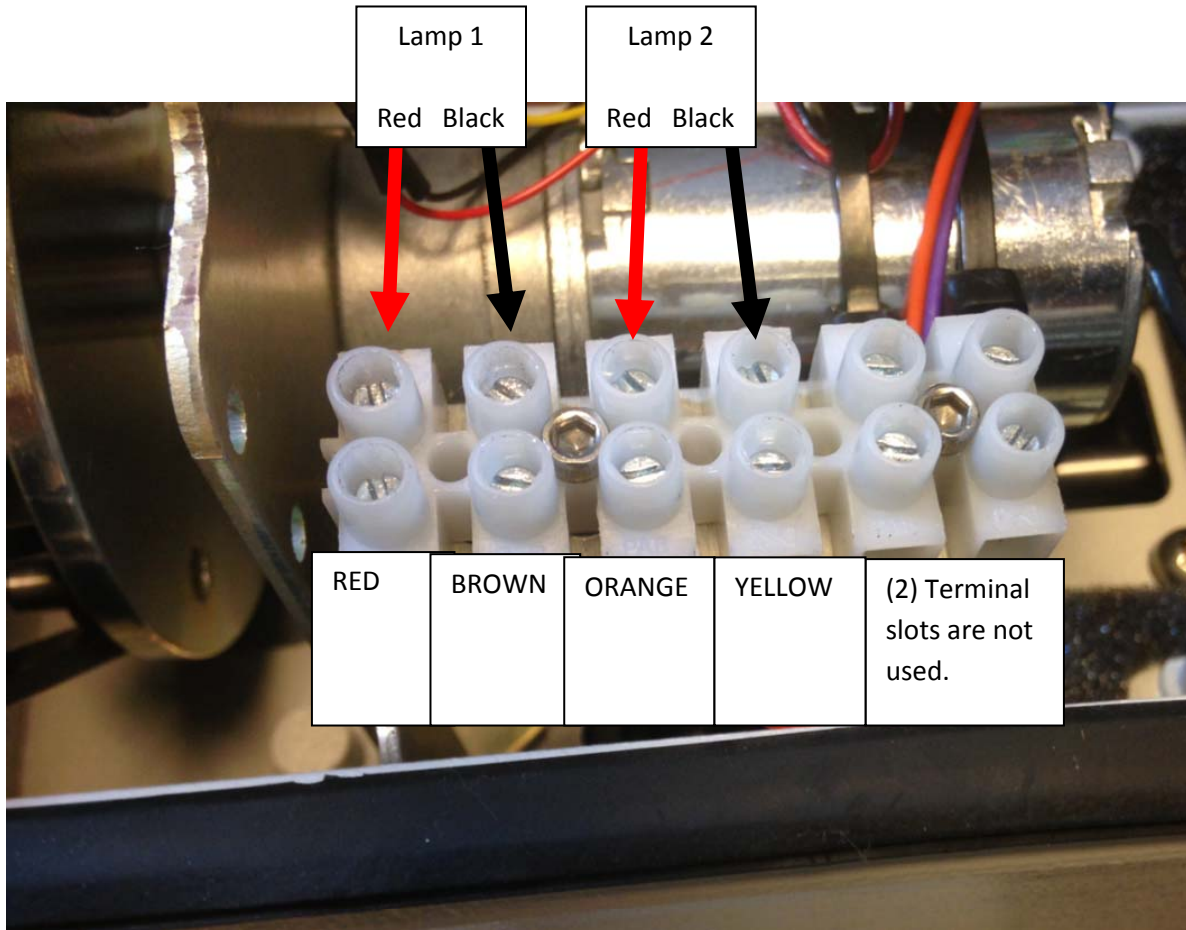

- d. Short the Orange and Purple wires from Lamp 1 together and secure with a wire nut. Repeat for Lamp 2. This step must be followed otherwise the lamps will not turn on.
 - e. The other wires in the lamp cable bundle are not used.
5. At the Esprit power module, make external connections for Esprit power, video, and communications per the standard Esprit installation guide.

6. At the Esprit power module, connect the lamp power wires to a 24VAC or 120/240VAC supply
 - a. Connect the Red & Brown wires to the 24VAC power source that will be used for lamp 1.
 - b. Connect the Orange & Yellow wires to the 24VAC power source that will be used for lamp 2.

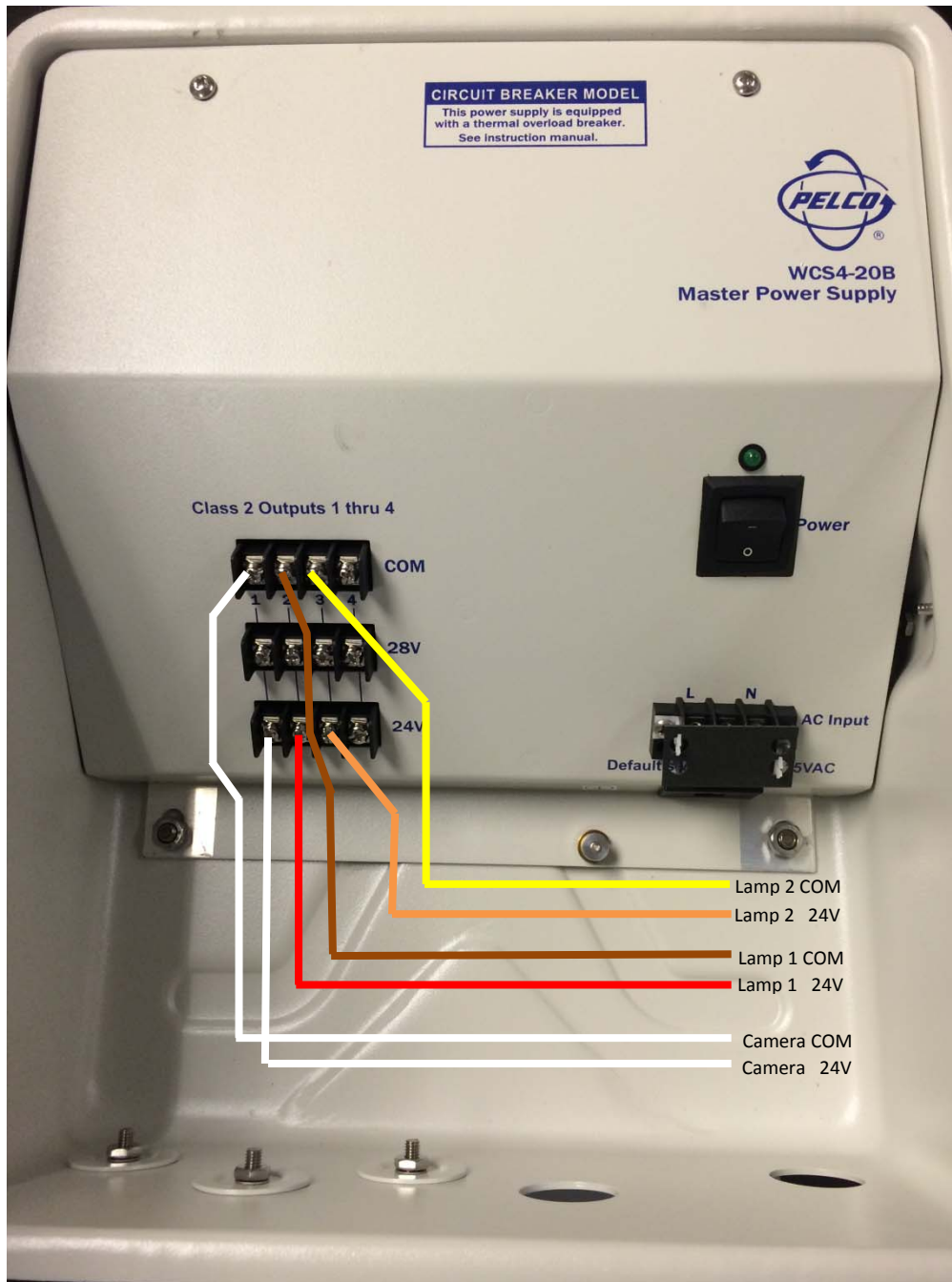

Operations:

7. Follow the operation guides that came with the Esprit and the lamps for set up and operation.
8. To ensure optimized performance with IR illumination, change the following settings on Esprit HD Only using the web interface as in the screen shot below.
 - a. Set “Max Gain” to 29 dB (default is 28).
 - b. Set “Max Exposure Time” to 66.67 msec (default is 125).

The screenshot displays the web interface for a PELCO Sarix™ camera. The page title is "Settings: IP Camera - ES5230-ADWET54". The navigation menu includes "System", "Network", "Imaging", "A/V Streams", "Users", and "Events". The "Imaging" tab is selected, showing the following settings:

- Exposure**
 - Mode: Normal Exposure Time / Gain Control
 - Max Gain (dB): 29 (highlighted in red)
 - Max Exposure Time (msec): 66.67 (highlighted in red)
 - Gain Boost:
- Day / Night**
 - Mode: Auto Manual
 - Transition Level: (Lighter → Darker): 1
- Back Light Compensation**
 - Mode: On Off
- Wide Dynamic Range Processing**
 - Mode: On Off

A "Live Preview" window on the right shows a video feed of a dirt road with a fence on the left side.

At the bottom left, there is a button labeled "Restore Settings to Defaults".

NOTES, UNLESS OTHERWISE SPECIFIED:

REVISIONS						
REV	ECD NO	ZONE	DESCRIPTION	DATE	BY	APPR
1	-	-	RELEASE	08-JUN-85	JM	

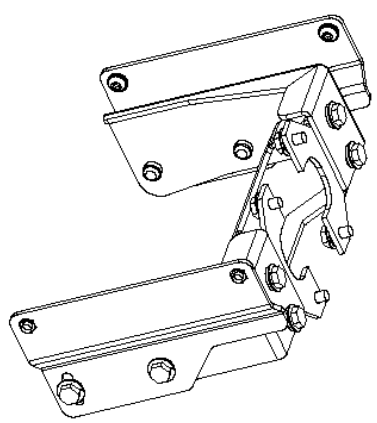
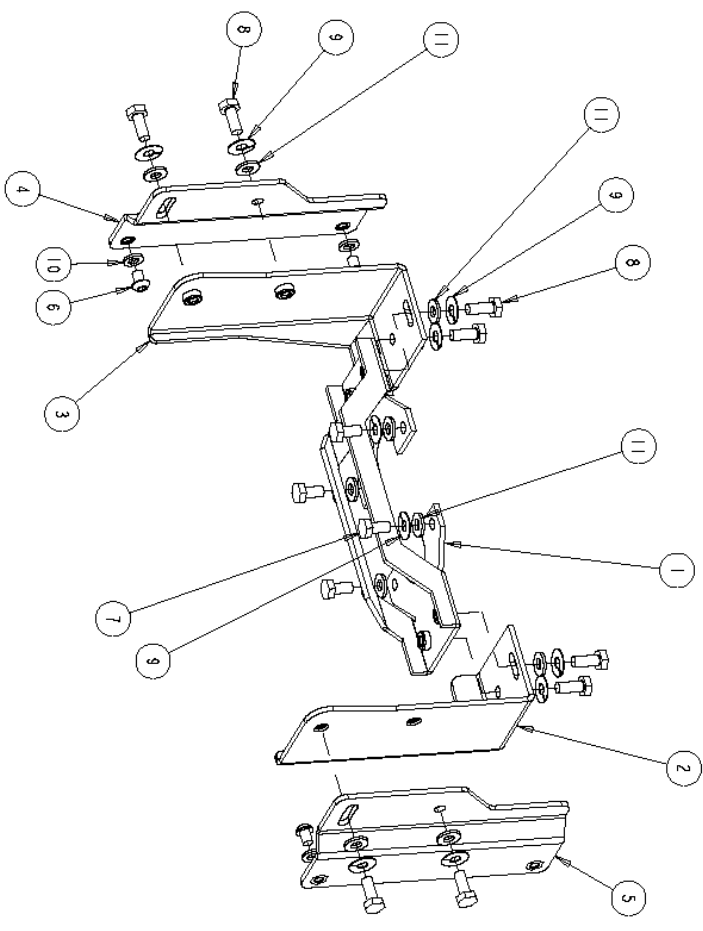

(COMPUTER DATA BASE DRAWING, PRO-E)

ITEM	QTY	PART NO	DESCRIPTION
1	1	21426200000000000000	IR BRKT ASSY, 18 SERIES
2	1	21426200000000000000	IR BRKT ASSY, 18 SERIES
3	1	21426200000000000000	IR BRKT ASSY, 18 SERIES
4	1	21426200000000000000	IR BRKT ASSY, 18 SERIES
5	1	21426200000000000000	IR BRKT ASSY, 18 SERIES
6	1	21426200000000000000	IR BRKT ASSY, 18 SERIES
7	1	21426200000000000000	IR BRKT ASSY, 18 SERIES
8	1	21426200000000000000	IR BRKT ASSY, 18 SERIES
9	1	21426200000000000000	IR BRKT ASSY, 18 SERIES
10	1	21426200000000000000	IR BRKT ASSY, 18 SERIES
11	1	21426200000000000000	IR BRKT ASSY, 18 SERIES

UNLESS OTHERWISE SPECIFIED:

THIS DOCUMENT AND THE DATA DISCLOSED HEREIN AND HEREWITH IS THE PROPERTY OF PELCO AND IS NOT TO BE REPRODUCED, USED OR DISCLOSED IN WHOLE OR IN PART, WITHOUT THE WRITTEN PERMISSION OF PELCO. ALL PATENT, PROPRIETARY DESIGN, USE, SALE, MANUFACTURING AND RIGHTS THERE TO ARE RESERVED BY PELCO

UNLESS OTHERWISE SPECIFIED DIMENSIONS ARE IN INCHES:

TOLERANCES: SURFACE TEXTURE:

.XX ± .02

.XXX ± .015

ANGLES ± °

FINISH: SEE BOM

DO NOT SCALE DRAWING

IR BRKT ASSY, 18 SERIES
SMRX-XXXXX

PELCO
Worldwide Leaders in Closed Circuit Video Systems
5800 PELCO WAY., CLOVIS, CALIFORNIA 93626-5699 USA

APPROVALS: DATE: 08-JUN-85

DWN: J. Marino

CHK: --

MECH: --

ELEC: --

PROJ: --

EDG: --

SIZE: DWG NO. RDXX-SMR-18_ASM
SCALE: 0.500 - 1 1/2 WT

REV: 1

SHEET 1 OF 1

INSPECTION DIMENSION

THIRD ANGLE PROJECTION

NEXT ASSY APPLICATION

USED ON

PELCO
Worldwide Leaders in Closed Circuit Video Systems